

**NORTHEASTERN UNIVERSITY  
EXP**

**BCDC  
July 30, 2019**



Northeastern University

**PAYETTE**

### ***Site Context***

- Provide model in context to get a better understand the massing and streetscape
- How does the open space work with the identity of the school as a whole?
- How does the landscape announce itself as a gateway to NU campus?
- This part of the NU campus is creating the “public realm” at the edge of Lower Roxbury
- Energized and redefined a significant piece of the city, feels like the High Line in NYC
- Don’t get timid, keep going

### ***Building Approach***

- Biggest challenge is living up to ISEC.
- Clover / shell diagram shows the pieces that are apparent in the floor plan
- Exterior skin appears too continuous, more articulation of the pieces
- Appears very opaque from Columbus (reaction to the Melnea Cass render)

### ***Public Comments***

- View from and paths connecting to Ruggles are important to consider
- Heat island effect identified in this part of the city, so need more trees and less pavement.



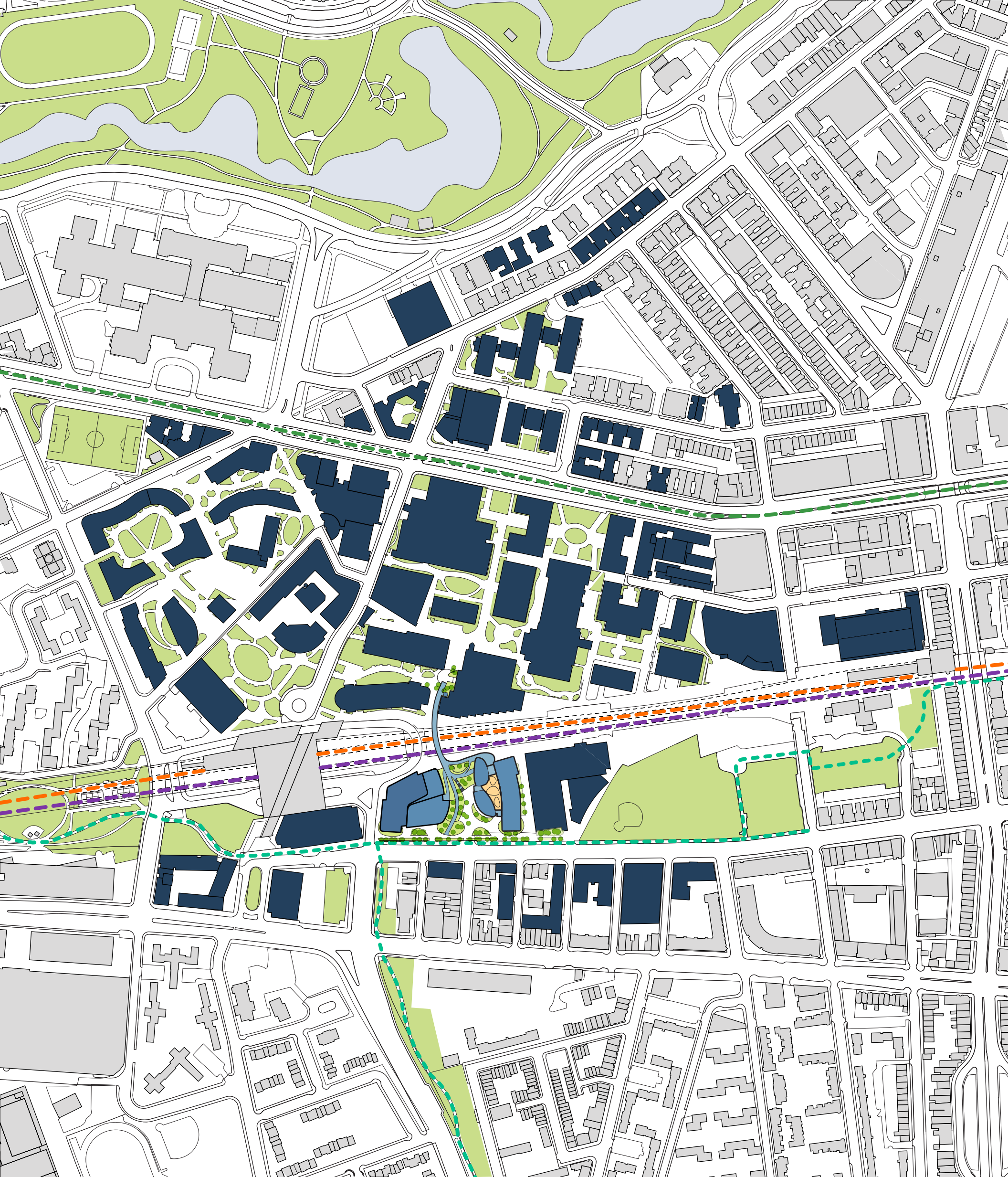







Pebbles in the Flow

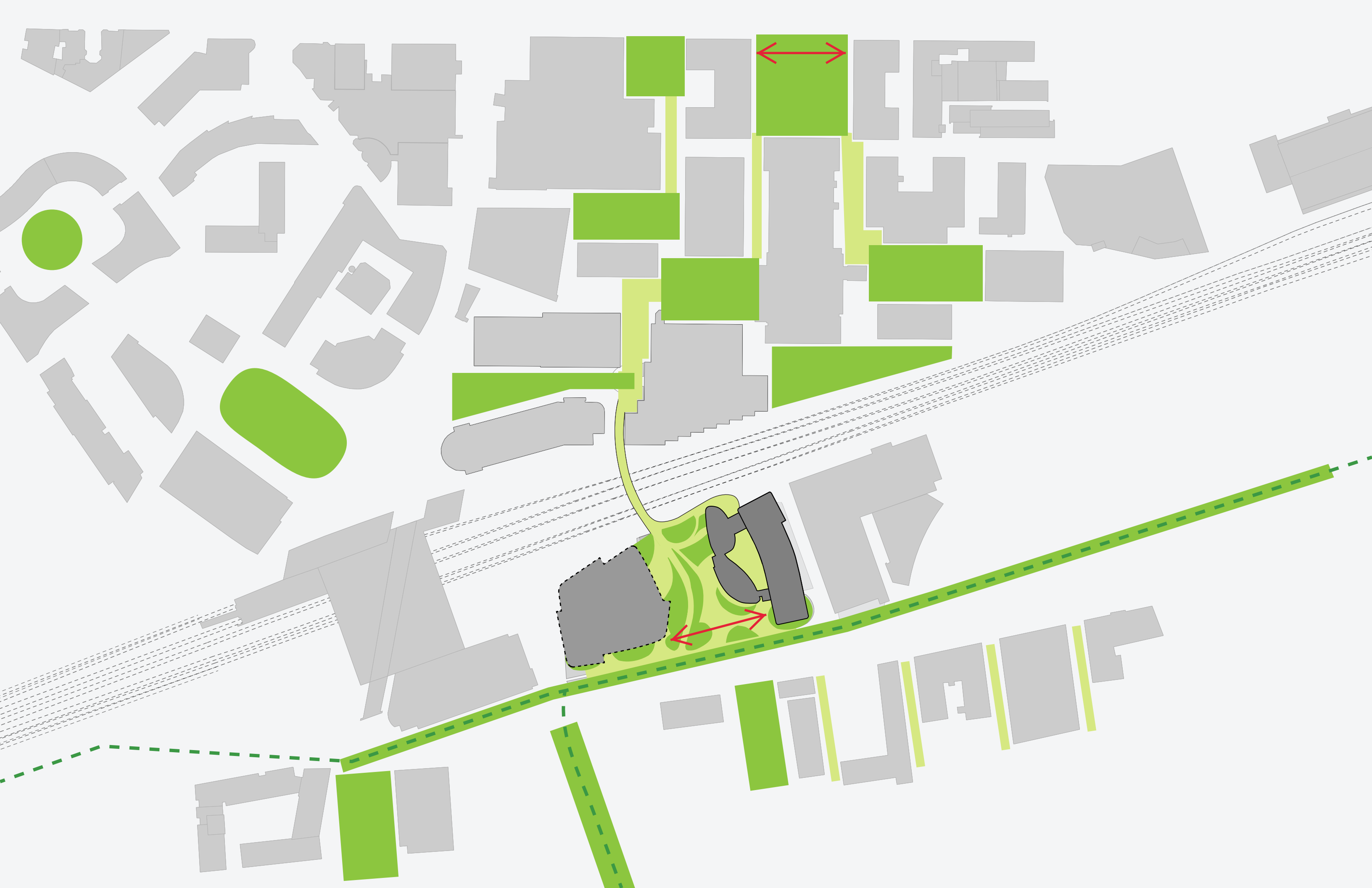

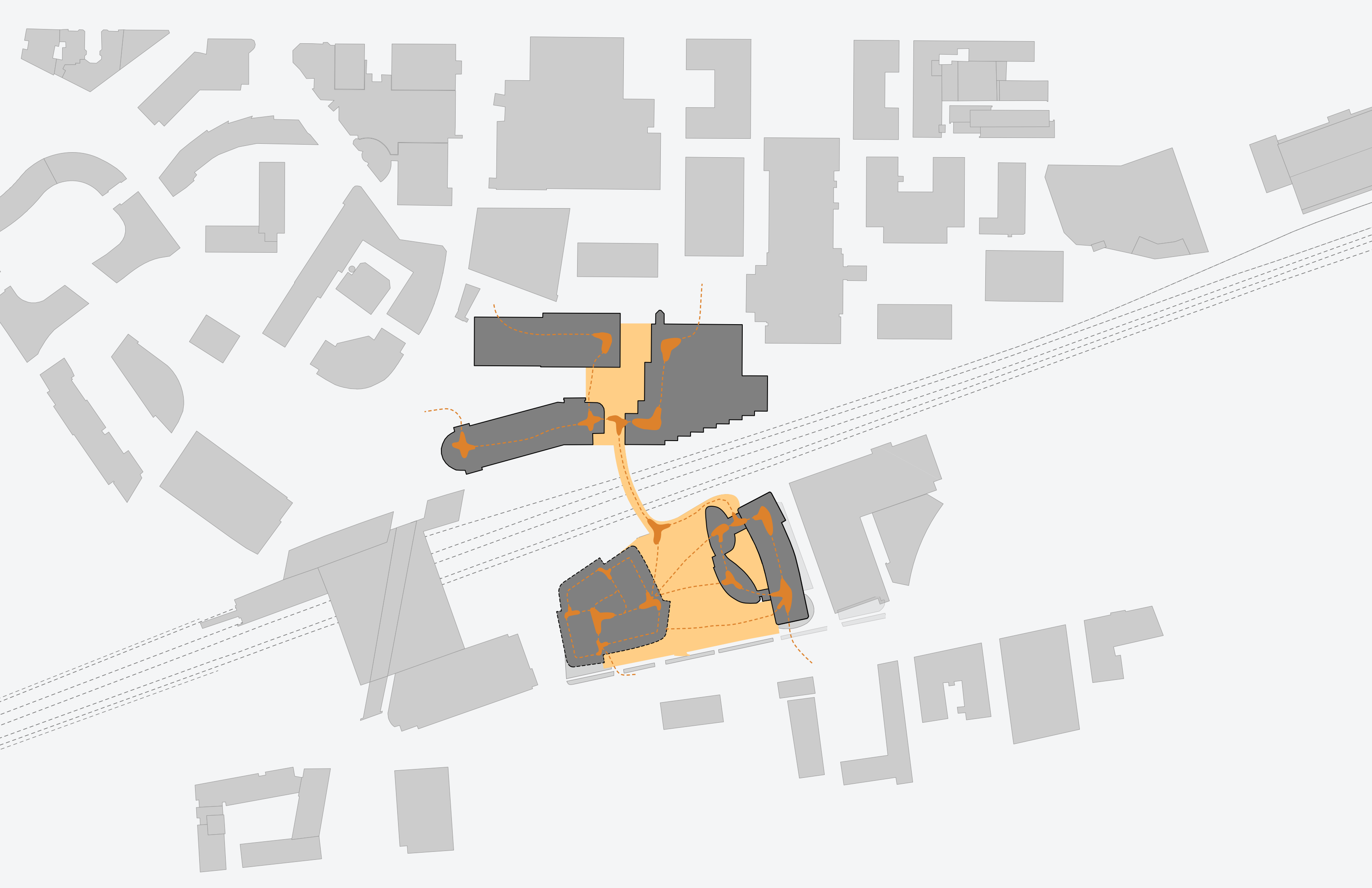



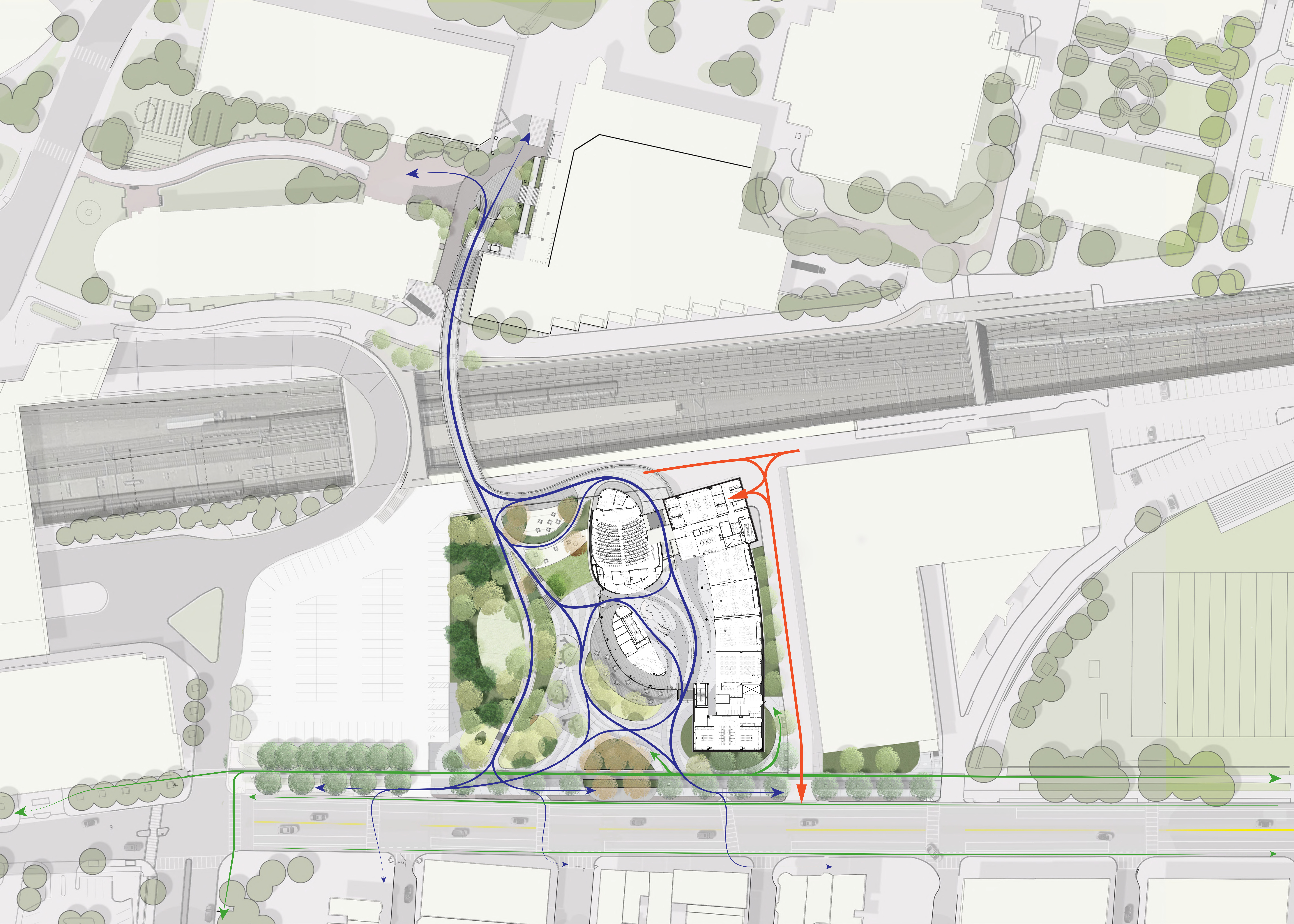



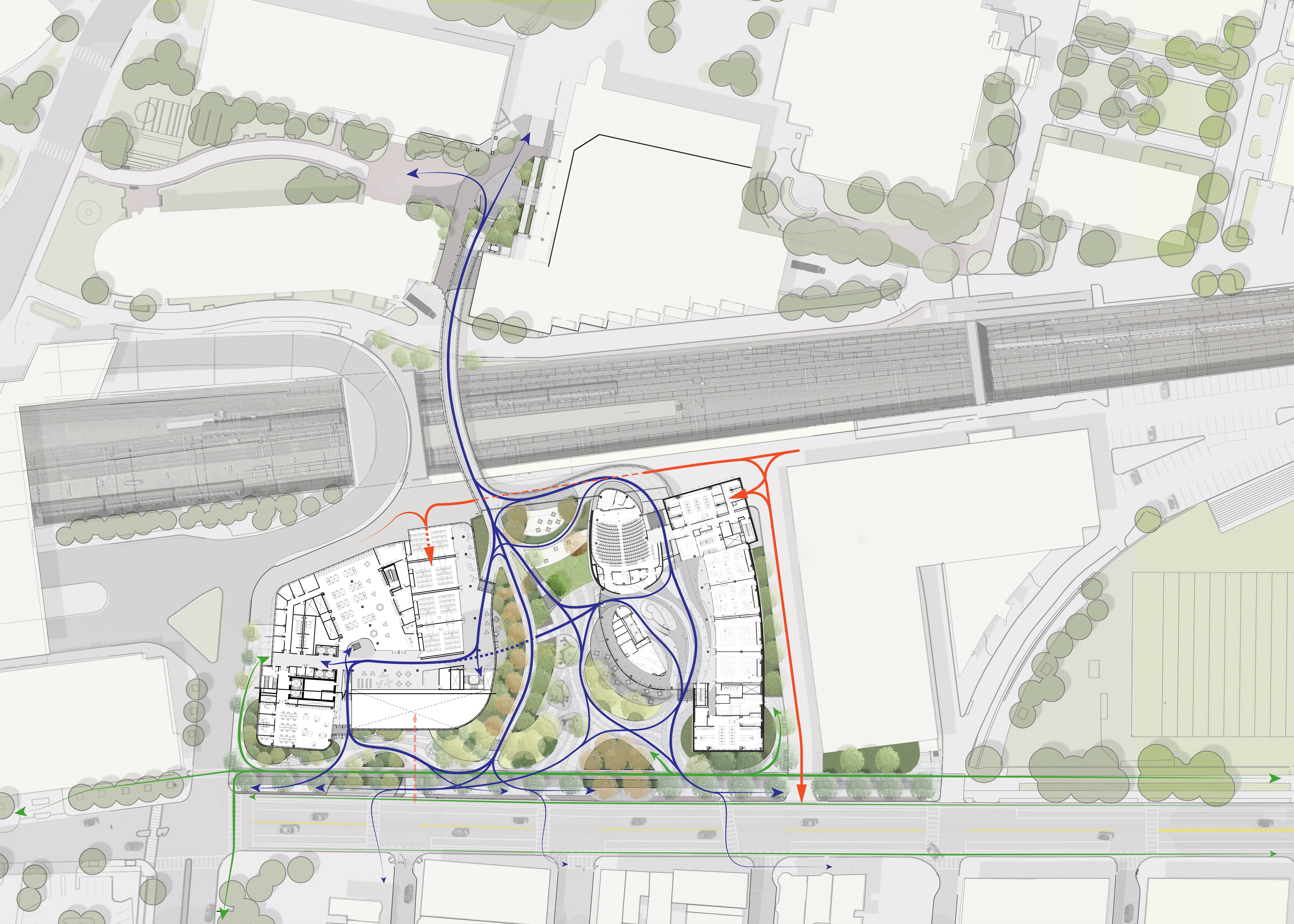



























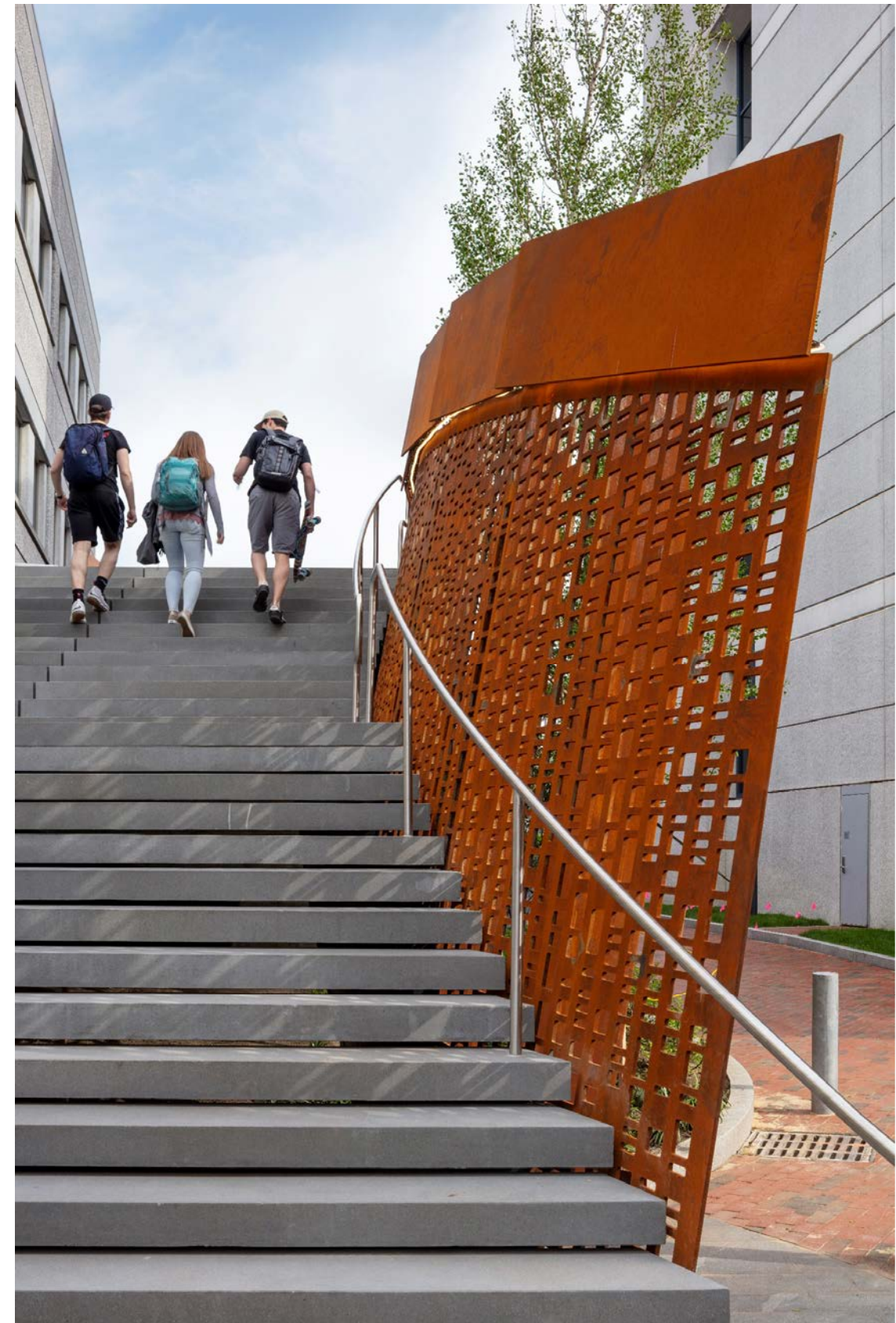
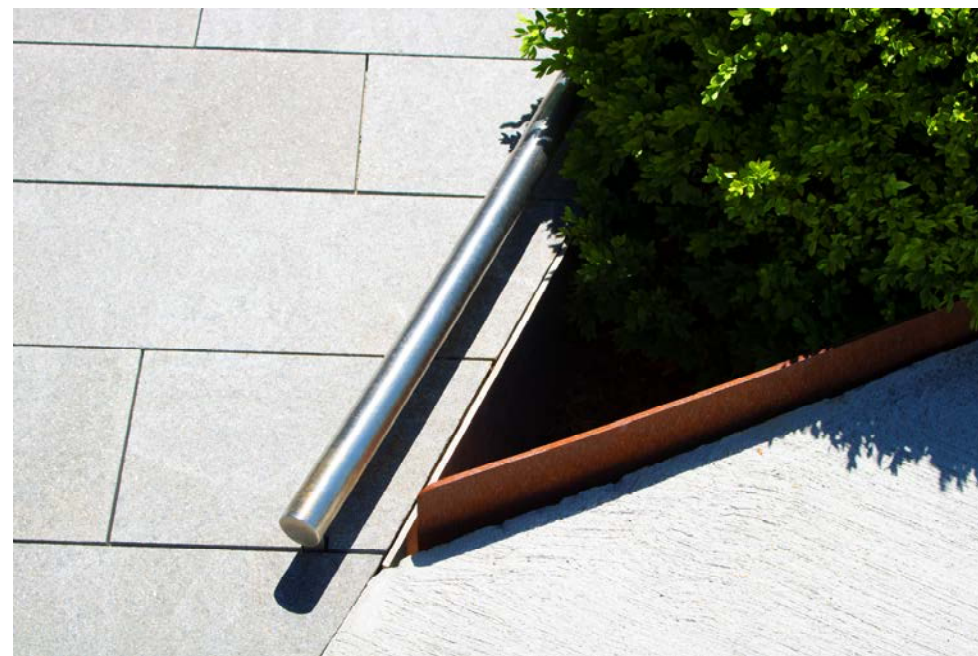



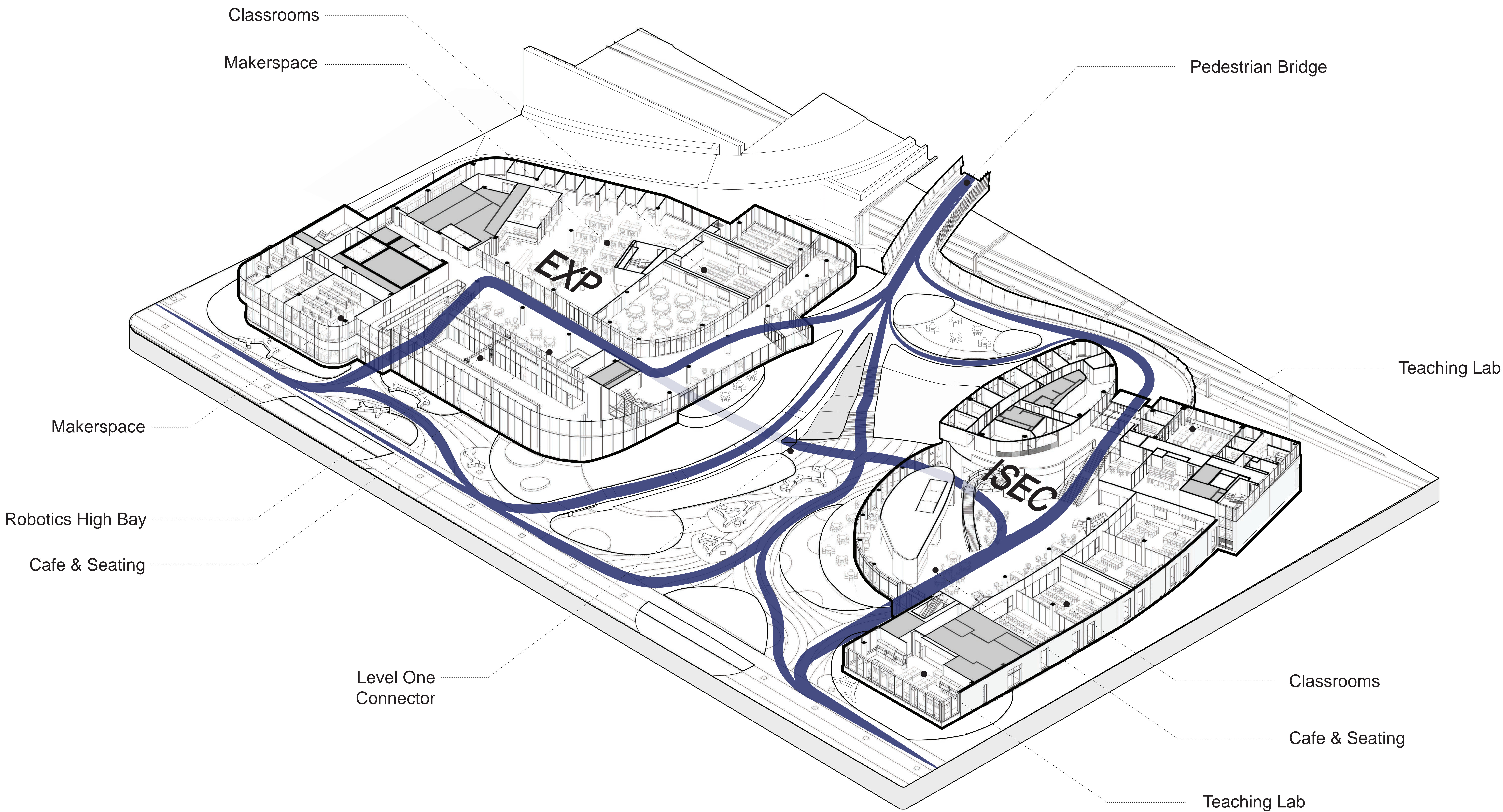



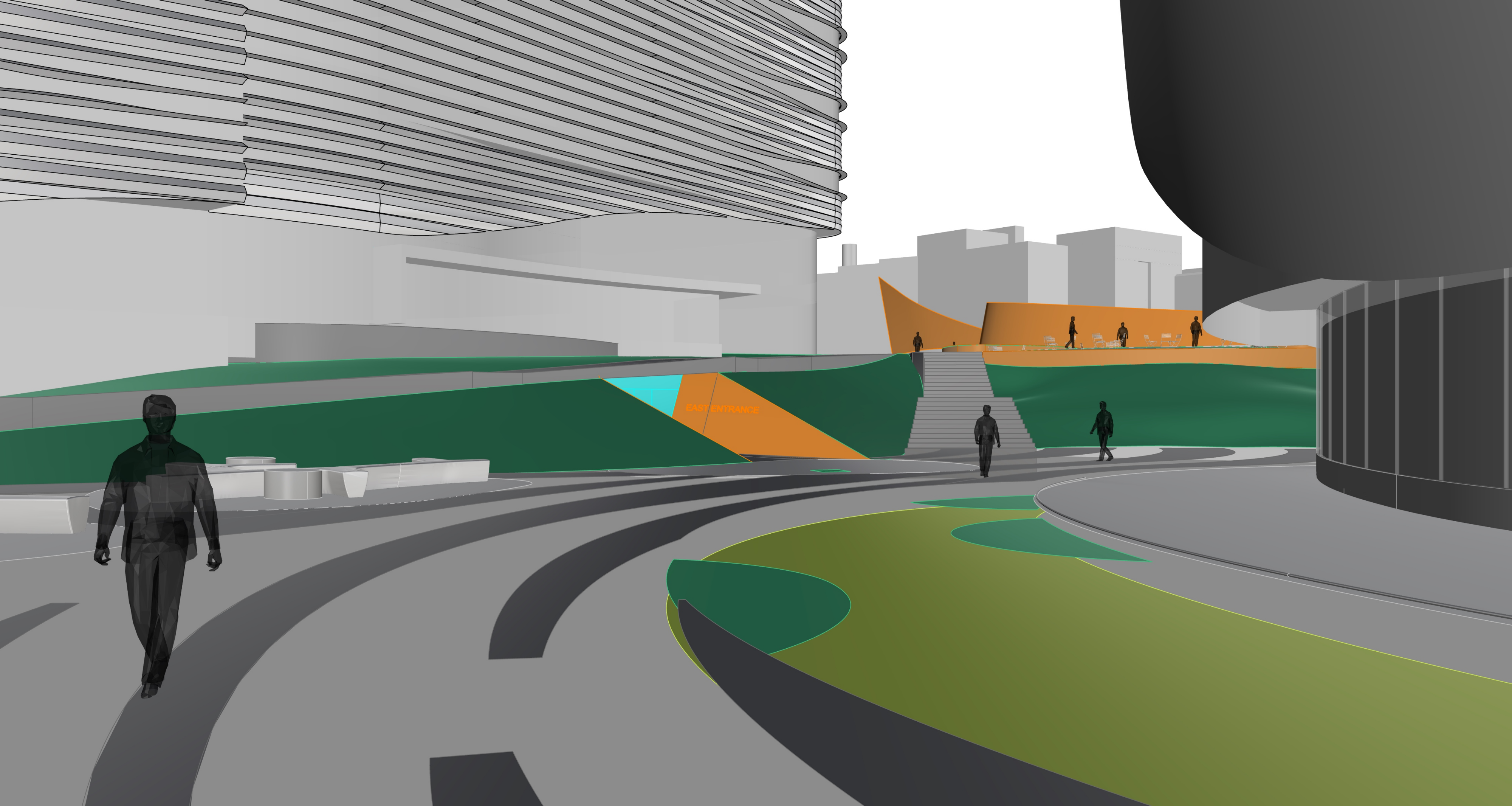



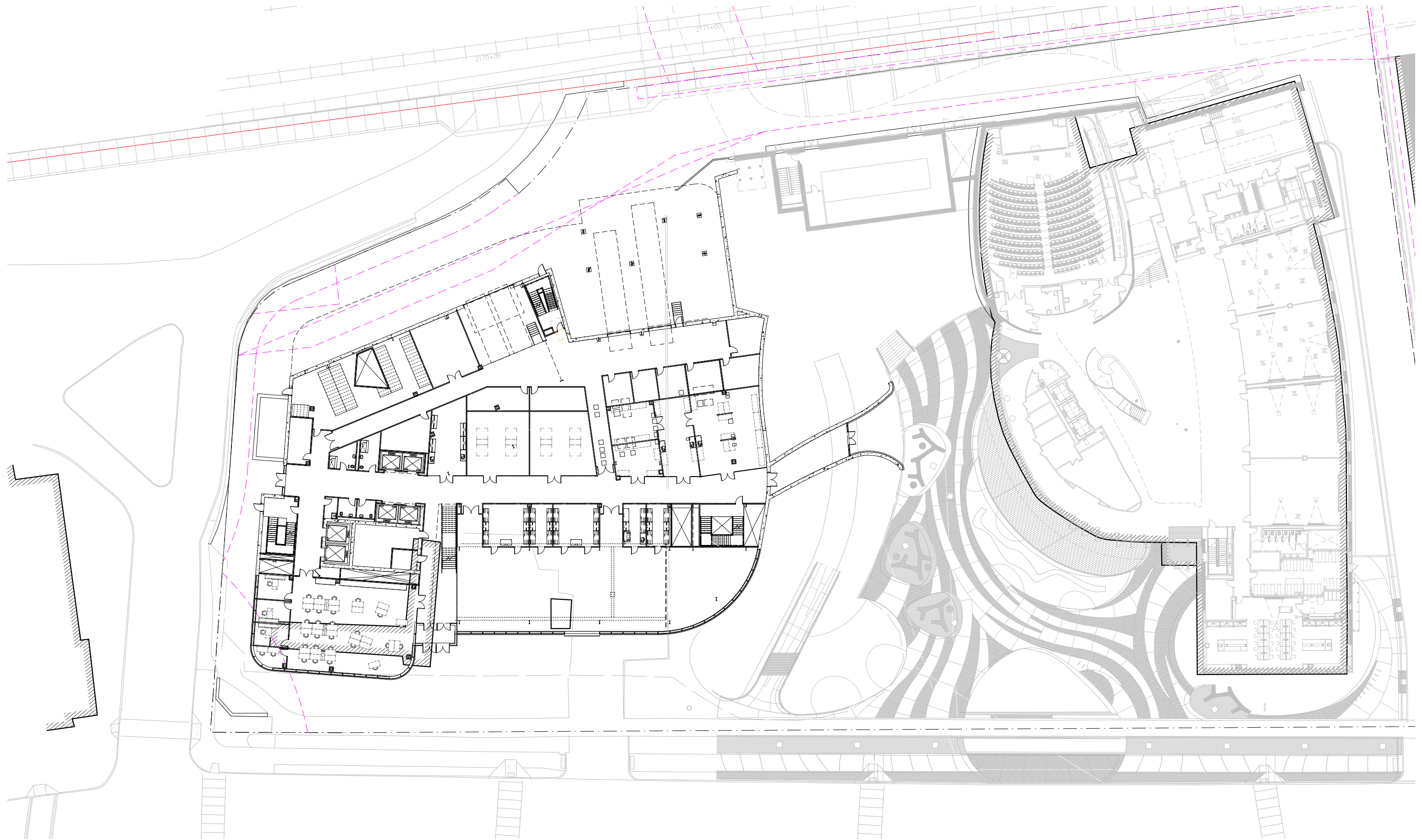

LEVEL 1



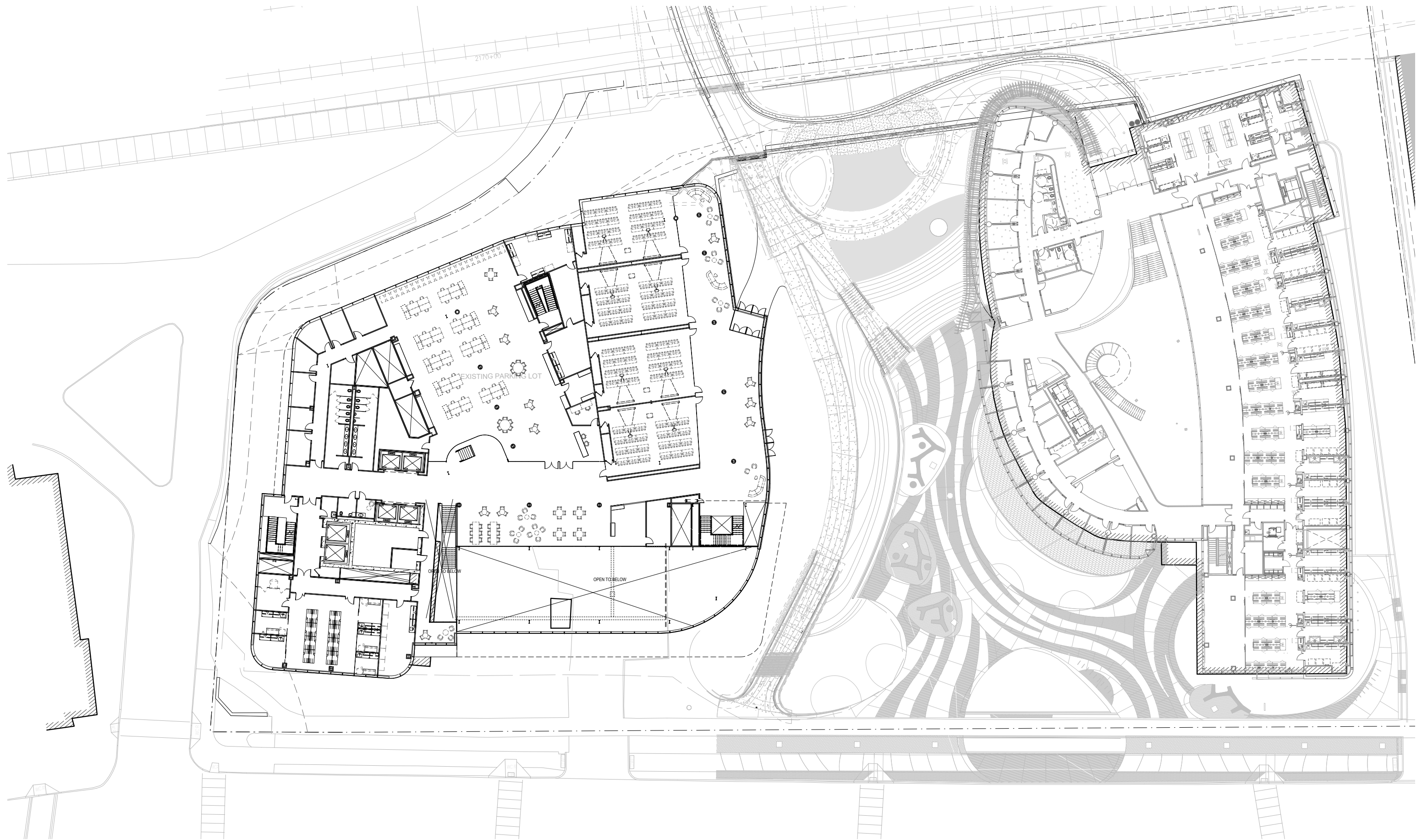

LEVEL 2



LEVEL 5



LEVEL 5 - UPDATED





LEVEL 5 - UPDATED



































